

SOFTSPAN™ EXTREMITY EXPANDERS

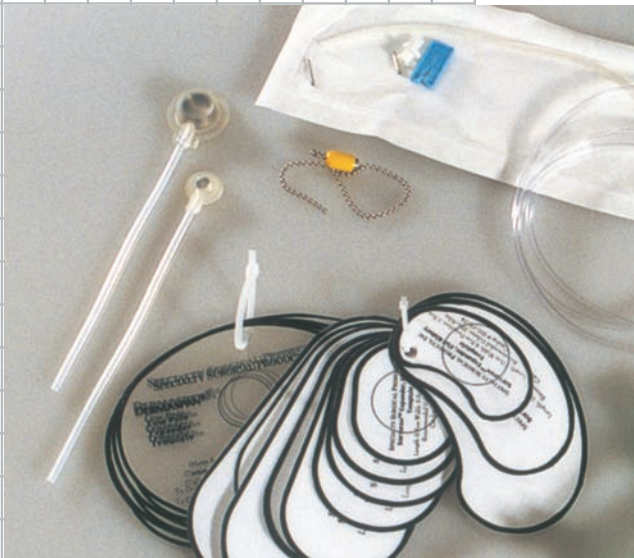

Accessories

Catalog #	Description
SET01	Softspan™ Expander Templates
PPL01	PRECISION POINT™ Pendulum™ Locator
WNIS01	Winged Needle Infusion Set
RPA01	Remote Port Accessory Set

Product supplied sterile. Each device supplied with either a PRECISION POINT™ Pendulum™ Locator or Remote Port Accessory Set, and Winged Needle Infusion Set. Please see package insert for additional product information.

Nominal Dimensions: Expander dimensions are measured at the minimum suggested fill volume with expander placed on a flat surface. Variations may occur and not every expander will conform exactly to the dimensions given.

Integrated Injection Ports Only/Magnetic Strength: This device contains a strong rare-earth magnet that has been tested to be detectable through 45mm phantom tissue. This magnet is contraindicated in MRI procedures and where the magnetic field may affect other polarized devices (e.g. drug infusion devices, pacemakers, artificial sensing devices and similar type products).

Limited Warranty, Limitation of Liability and Disclaimer of Other Warranties: SSP warrants that reasonable care was used in the manufacture and production of this product. Because SSP has no control over the conditions of use, patient selection, surgical procedure, post-surgical stresses, or handling of the device after it leaves our possession, SSP does not warrant either a good effect or against an ill effect following its use. SSP shall not be responsible for any incidental or consequential loss, damage or expenses directly or indirectly arising from the use of this product. This warranty is in lieu of and excludes all other warranties not expressly set forth herein, whether express or implied by operation of law or otherwise, including, but not limited to any implied warranties of merchantability or fitness for use.

Order for Dr.:	
Patient:	
Surg. Date:	
Catalog #:	Qty:
_____	_____
_____	_____
_____	_____
_____	_____
_____	_____
_____	_____



Toll Free 888.878.0811
 406.961.0102 • Fax: 406.961.0103 • 1131 North U.S. Hwy 93 • Victor, MT 59875
 email: info@ssp-inc.com

SOFTSPAN™

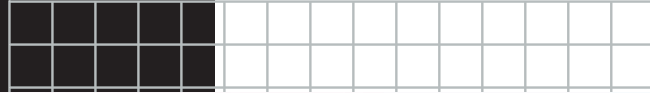

Extremity Expanders

The SSP Softspan™ Tissue Expander design concept is the minimization of all critical potential erosion points. To this end, SSP has developed low and flat profile expander designs that can be used in the most difficult of cases while minimizing traditional areas of concern.

The smooth rectangle shaped expander incorporates Dr. Bruce Bauer's years of clinical experience in dealing with the most difficult reconstructive expander cases. Rounding of all edges and a remote injection port with the lowest possible point of attachment reduces the initial profile of expander.

The curvilinear and angle expanders encompass Dr. Hugh Vu's considerable experience with pediatric and adult burn reconstructive cases. Designed to address the unique requirements of large defect reconstruction, the zone texturing utilizes the assets of both smooth and textured surfaces, allowing for ease of expander insertion as well as secure expander/tissue interface.

YOUR
RECONSTRUCTIVE
SPECIALISTS-
REBUILDING
LIVES

SPECIFIC DESIGN POINTS:

- **Low Profiles** reduce initial profile of expanders.
- **Rounding of all edges** and reduced profiles of all critical reinforced areas minimize potential erosion points.
- **Reinforced Bases** facilitate placement and "roll-out" of expanders.
- **Integrated Precision Point™** magnetic injection port system or remote port options offer flexibility for each unique case.
- **Smooth, Textured, or Zone-Textured** surface options.
- **Winged Needle Infusion Set** conveniently supplied sterile with each expander for incremental filling with your delivery system of choice.



Custom shapes and sizes also available.

SOFTSPAN™ EXTREMITY EXPANDERS

Expander Shape	Remote Port Cat #		Integrated Port Cat #		Suggested Fill Volume	A Length	B Width	C Projection
	Smooth Shell	Textured Shell	Smooth Shell	Textured Shell				
Flat Oval	SRE-FO-0255*	SRE-FO-025*	None	SIE-FO-65	25-62cc	6.5cm	5.0cm	1.5-4.0cm
	SRE-FO-0355*	SRE-FO-035*	None	SIE-FO-76	35-89cc	7.5cm	6.0cm	1.5-4.3cm
	SRE-FO-060S	SRE-FO-060	None	SIE-FO-86	60-150cc	8.5cm	6.5cm	1.5-5.2cm
	SRE-FO-075S	SRE-FO-075	None	None	75-188cc	10.0cm	8.0cm	1.5-5.5cm
Flat Kidney	SRE-FK-025S	SRE-FK-025	None	SIE-FK-74	25-62cc	7.0cm	4.5cm	1.5-3.5cm
	SRE-FK-080S	SRE-FK-080	None	SIE-FK-106	80-200cc	10.0cm	6.0cm	2.0-5.5cm
	SRE-FK-140S	SRE-FK-140	None	SIE-FK-127	140-350cc	12.5cm	7.5cm	2.5-6.5cm
	SRE-FK-270S	SRE-FK-270	None	None	270-675cc	14.0cm	9.0cm	4.0-8.0cm
Low Rectangle	None	None	SIE-LR-064S	SIE-LR-064	60-120cc	6.0cm	4.0cm	3.5-5.0cm
	SRE-LR-160S	SRE-LR-160	SIE-LR-106S	SIE-LR-106	160-320cc	10.0cm	6.0cm	3.5-6.2cm
	SRE-LR-200S	SRE-LR-200	SIE-LR-126S	SIE-LR-126	200-400cc	12.0cm	6.0cm	3.5-6.8cm
	SRE-LR-250S	SRE-LR-250	SIE-LR-127S	SIE-LR-127	250-500cc	12.0cm	7.0cm	3.8-7.4cm
Rectangle	SRE-LR-340S	SRE-LR-340	SIE-LR-157S	SIE-LR-157	340-680cc	15.0cm	7.5cm	3.8-8.0cm
	BTE070	SPR070	None	None	70-90cc	6.0cm	4.0cm	3.5-4.6cm
	BTE250	SPR250	None	None	250-300cc	10.0cm	6.0cm	5.0-6.3cm
	BTE350	SPR350	None	None	350-420cc	12.0cm	6.0cm	5.0-7.0cm
Crescent	BTE500	SPR500	None	None	500-600cc	12.0cm	7.0cm	6.0-7.8cm
	BTE750	SPR750	None	None	750-900cc	15.0cm	7.5cm	7.0-9.0cm
	BTE1000	SPR1000	None	None	1000-1200cc	17.0cm	8.0cm	8.0-10.2cm
	SRE-CR-045S	SRE-CR-045	SIE-CR-045S	SIE-CR-045	45-90cc	8.7cm	5.5cm	2.7-4.5cm
SRE-CR-100S	SRE-CR-100	SIE-CR-100S	SIE-CR-100	100-200cc	10.5cm	7.4cm	3.3-5.8cm	
SRE-CR-200S	SRE-CR-200	SIE-CR-200S	SIE-CR-200	200-400cc	13.7cm	10.5cm	4.0-7.0cm	
SRE-CR-350S	SRE-CR-350	SIE-CR-350S	SIE-CR-350	350-700cc	15.0cm	11.2cm	5.5-8.5cm	

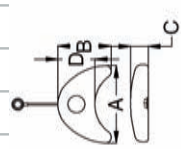
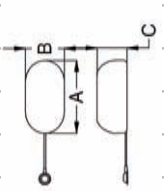
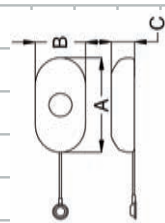
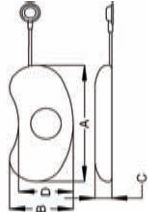
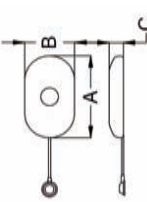

*No reinforced base on this size

SOFTSPAN™ EXTREMITY EXPANDERS

Expander Shape	Remote Port Cat # Smooth Shell	Integrated Port Cat # Textured Shell	Smooth Shell	Textured Shell	Suggested Fill Volume	A Length	B Width	C Projection
Round	SRE-RD-220S	SRE-RD-220	None	None	220-270cc	9.4cm	9.4cm	4.5-5.9cm
	SRE-RD-270S	SRE-RD-270	None	None	270-320cc	10.2cm	10.2cm	4.8-6.0cm
	SRE-RD-320S	SRE-RD-320	None	None	320-380cc	10.8cm	10.8cm	5.0-6.4cm
	SRE-RD-380S	SRE-RD-380	None	None	380-430cc	11.3cm	11.3cm	5.4-6.5cm
	SRE-RD-430S	SRE-RD-430	None	None	430-500cc	11.5cm	11.5cm	5.6-6.9cm
	SRE-RD-500S	SRE-RD-500	None	None	500-640cc	12.2cm	12.2cm	6.0-8.0cm
	SRE-RD-640S	SRE-RD-640	None	None	640-750cc	13.1cm	13.1cm	6.7-8.2cm
	SRE-RD-750S	SRE-RD-750	None	None	750-860cc	14.0cm	14.0cm	6.9-8.5cm
	SRE-RD-860S	SRE-RD-860	None	None	860-1020cc	14.5cm	14.5cm	7.7-9.0cm
	Curvilinear	SRE-CV-320S	SRE-CV-320	None	VU-CTE-320	320-480cc	19.0cm	6.5cm
SRE-CV-520S		SRE-CV-520	None	VU-CTE-520	520-780cc	23.8cm	7.5cm	4.5-7.0cm
SRE-CV-720S		SRE-CV-720	None	VU-CTE-720	720-1080cc	26.2cm	9.0cm	4.7-7.5cm
Angle	None	None	None	VU-ATE-200	200-300cc	19.0cm	4.0cm	3.5-4.5cm
	None	None	None	VU-ATE-450	450-650cc	23.5cm	5.0cm	4.5-6.0cm
Wedge	SRE-WG-100S	SRE-WG-100	None	None	100-120cc	8.3cm	5.5cm	4.5-5.5cm
	SRE-WG-250S	SRE-WG-250	None	None	250-300cc	10.5cm	7.5cm	6.0-7.3cm
Calif	SRE-CC-500S	None	None	None	500-600cc	19.0cm	8.0cm	5.5-7.0cm

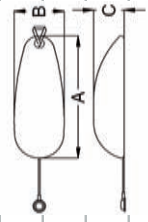
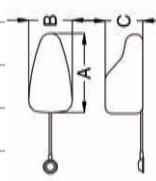
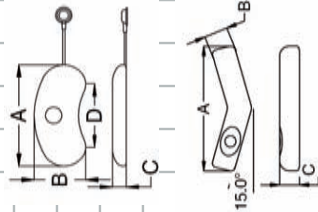
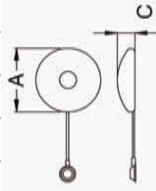

Toll Free 888.878.0811

406.961.0102 • Fax: 406.961.0103 • 1131 North U.S. Hwy 93 • Victor, MT 59875

email: info@ssp-inc.com

